

# GRIPPS®

## GRIPPS® Technical Specification Sheet.

### GRIPPS® Tape Measure Catch and Latch Models: H02056, H02057, H02058, H02059



**H02056**  
Tape Measure Catch  
**Max Load:** 1.0kg / 2.2lbs  
**ANSI/ISEA 121-2018**  
**COMPLIANT**

**H02057**  
Tape Measure Latch  
**Max Load (D-Ring):**  
2.5kg / 5.5lbs  
**Max Load (Retractor):**  
0.7kg / 1.5lbs  
**ANSI/ISEA 121-2018**  
**COMPLIANT**



**H02058**  
Retractable Tape Measure  
Latch  
**Max Load (D-Ring):**  
2.5kg / 5.5lbs  
**Max Load (Retractor):**  
0.7kg / 1.5lbs  
**ANSI/ISEA 121-2018**  
**COMPLIANT**

**H02059**  
Retractable Tape Measure  
Latch Kit  
**Max Load:** 0.7kg / 1.5lbs  
**ANSI/ISEA 121-2018**  
**COMPLIANT**

#### FOR PRODUCT SUPPORT CONTACT:

support@gripps.com | +61 3 8383 9458

WWW.GRIPPS.COM

## GRIPPS® Tape Measure Catches and Tape Measure Latches

### SAFETY INFORMATION

**⚠️ WARNING** Before using the GRIPPS® Tape Measure Catch and Latch, read all provided safety information pertaining to the use of your Dropped Tool Prevention (DTP) device. **FAILURE TO DO SO COULD RESULT IN INJURY OR DEATH.**

The user of a DTP device bears the responsibility of reading all safety information contained herein. Keep this manual for future reference.

#### Intended Use:

When used properly, GRIPPS® Tape Measure Catch and Latch can prevent workplace hazards resulting from dropped tools. These may include personal injury and material damage.

GRIPPS® does not approve use of this device for any activities not described in the User Instructions. This device is not intended to be used in any recreational activity, as a personal fall-arrest device or in any other manner not described herein.

**⚠️ WARNING** Misuse of this device could result in serious injury or death.

Adhere to all manufacturer recommendations regarding the operation and maintenance of this device. For additional information, contact GRIPPS® customer support.

Read and adhere to the following in order to ensure correct operational functionality:

- Your DTP should never be used as a personal fall-arrest device or restraint system.
- Do not use this device with tools that exceed the specified maximum load/weight.
- A DTP device used in applications that exceed the limits of operation specified by the manufacturer should be considered unsafe and should be replaced.
- Do not tether a tool over 2.5kg/5.5lbs directly to your clothing or person.
- Inspect your DTP device before each use.
- Ensure the DTP device is securely connected to a load rated tool connector or anchor point before use.
- Inspect any tool connector point before it is connected to the DTP device.
- Modification of the DTP device voids all warranties and violates manufacturer recommendations.
- Do not use a tool that cannot be connected to your DTP in the manner specified by GRIPPS®.
- It is unsafe to extend the length of the DTP product by any means.
- Do not use this product if it will create an unsafe working environment.
- Ensure the tether does not become entangled with other workers, yourself or surrounding objects. Leave enough space between yourself and any hazards so that a tool on a fully extended tether can swing unobstructed should it fall.
- Avoid contact between the tether and rough or sharp edges.
- Use extra precaution around moving machinery, moving parts, electrical hazards, extreme temperatures, chemical hazards, or combustion hazards.

- All connected tools and equipment, including connection points, must be compatible for use with this DTP device.
- Always wear appropriate personal protective equipment.
- If a tether has arrested a dropped tool or object, it should be taken out of service and replaced.
- All procedures shown in this instruction are for GRIPPS® Tool Holster products only.

### GENERAL USE AND CARE

The GRIPPS® Tape Measure Catch is designed to encase a tape measure so it can be safely connected to a tool tether at heights. Engineered to be used with the GRIPPS® Tape Measure Catch, the Tape Measure Latch enables quick tethering and holstering of tape measures. With a mounted quick-connect platform, users can quickly and easily secure a Tape Measure when not used.

#### Before Use:

Thoroughly inspect your GRIPPS® DTP device before each use. Do not use any component that presents deformities or deterioration. Inspect all material including the carabiner and tether.

### HOW TO USE / INSTRUCTIONS:

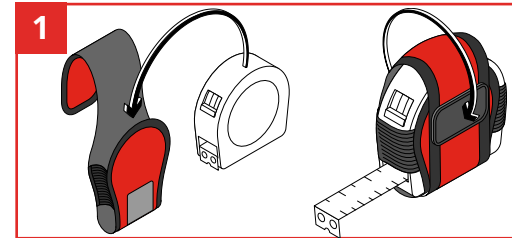

Fit tape measure into catch.

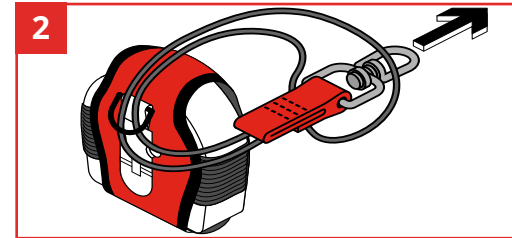

If using a GRIPPS® Swivel Catch, feed cord through D-Ring on the back of Tape Measure Catch. Then attach to the tool-ring from the retractor unit.

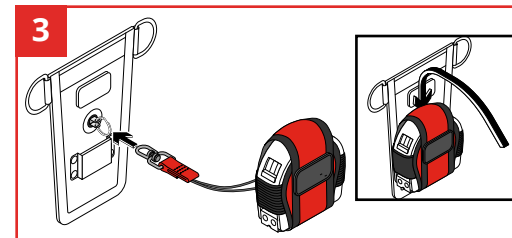

The Tape Measure Catch can now slide onto the Tape Measure Latch.

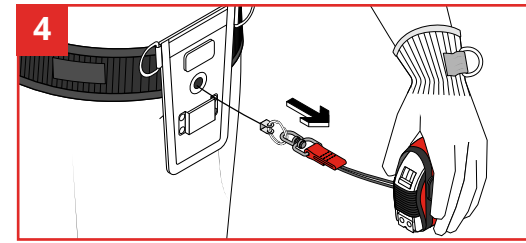

Attach holster to your work belt by sliding belt through the rear straps of the Tape Measure Latch Holster.

#### After Use Care:

Clean and inspect the Tape Measure Catch and Latch, tethers and connected tool. For tougher stains, use warm water and a mild soap or detergent. Do not use again until dry.

Store in a clean and dry environment. Proper care will help to ensure that it will operate effectively and extend its service.

# GRIPPS®

linkedin.com/company/grippsglobal

facebook.com/grippsglobal

youtube.com/@gripps3480grippsglobal

instagram.com/grippsglobal