

V-TEC™ Mini Personal Fall Limiter

Impressive Innovation in a Compact Size

MSA
The Safety Company



WE KNOW WHAT'S AT STAKE.

V-TEC Mini PFL

Compact and Versatile

The V-TEC Mini is the most compact & lightweight self-retracting lanyard ever developed using multiple spring radial energy-absorbing technology. This new design eliminates the need for an external energy-absorber outside of the housing making it the smallest personal fall limiter on the market.

Reliable and Reassuring

MSA's Lifecycle Warranty means users can work at height with confidence that the V-TEC Mini will continue to provide safety when it matters most. The product offers fall arrest and restraint for users 60 to 140 kg including tools.

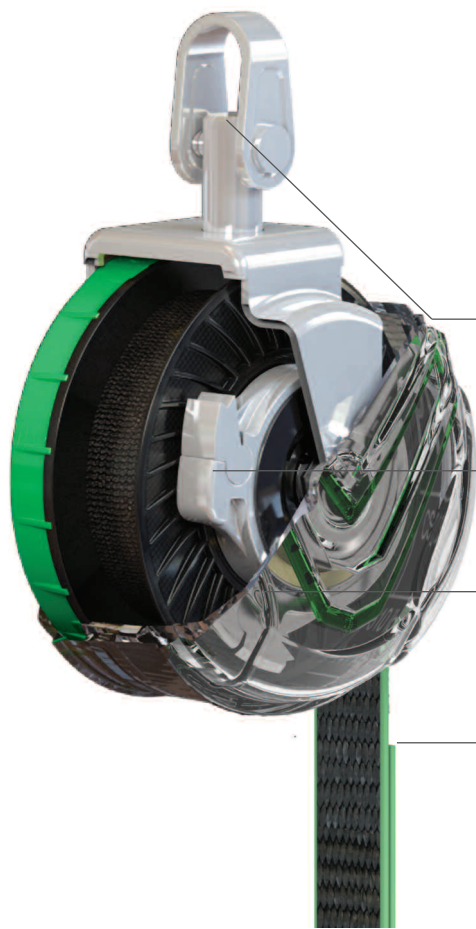

Single-Leg

The world's first self-retracting lifeline with multiple spring radial energy-absorbing technology

- Integral energy absorber
- Requires zero recalibration or adjustment
- The energy absorber is completely sealed from external contaminants

Free range of motion

A fully rotating attachment point for complete flexibility – both 360° and 180°

Precision engineering

A structurally reinforced pawl mechanism

Highly durable

A polycarbonate case houses the SRL, and its transparency allows for easy visual inspection of critical internal components

Superior materials

Components manufactured from high-grade stainless steel and engineered plastics



Twin-leg

The V-TEC Twin Mini uses a TwinLink to connect two Mini PFLs.

This lightweight attachment allows the configuration to provide all the features of a Mini PFL, with greater mobility and continuous attachment, whilst working on complex structures.



The V-TEC Mini webbing 1.8 m is specifically tested and suitable for use on MEWPs (Mobile Elevating Working platforms) in Europe (Prüfgrundsatz PG -06-07). Maximum load capacity of the device on MEWP applications is 100 kg (including tools).

When used on a MEWP the device shall be secured to the harness dorsal d-ring and the lanyard connected to the basket anchor point at least 400 mm below the handrail.

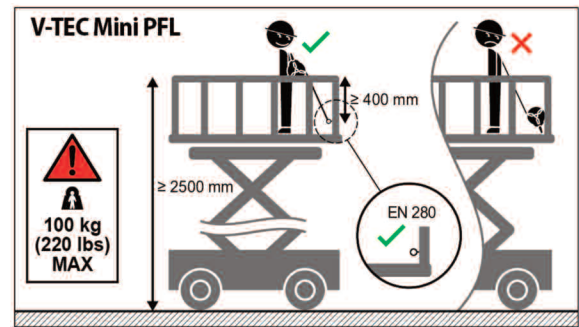

Available Connectors

The V-TEC Mini is supplied with a choice of steel or aluminium top carabiner and has a range of connectors available.

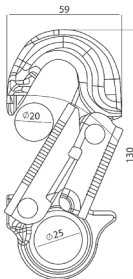

Forged Steel Snaphook

- High-tensile steel material
- Zinc-plated finish
- EN, ANSI and CSA compliant

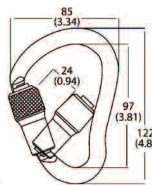

Carabiner/Hook

- Triple-locking gate
- Aluminium alloy
- EN, ANSI and CSA compliant

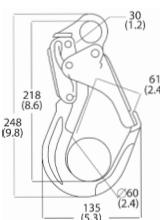

Aluminium Scaffold Hook

- Aluminium alloy
- EN, ANSI and CSA compliant

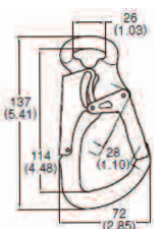

Aluminium Snaphook

- Lightweight
- EN compliant

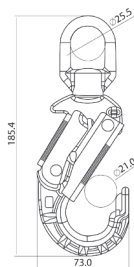

Forged Steel Swivel Snaphook

- Double-action/self-locking gate
- High-tensile steel material
- Zinc-plated finish
- EN, ANSI and CSA compliant

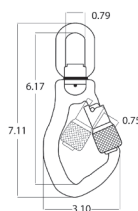

Swivel Carabiner/Hook

- Triple-locking gate
- Aluminium alloy
- EN, ANSI and CSA compliant

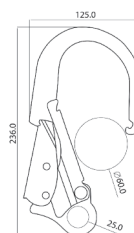

Steel Scaffold Hook

- High-tensile steel material
- Zinc-plated finish
- EN, ANSI and CSA compliant

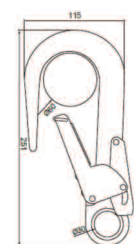

Aluminium hook

- Aluminium alloy
- Black anodized
- Lightweight
- EN compliant

Standards

The V-TEC Mini has a highly durable polycarbonate, clear casing which allows for easy visual inspection of the critical internal components. It can withstand temperatures ranging from -40° to +54°C and its high-performing, high-strength webbing lifeline has been manufactured to the highest standard in accordance to MSA strict quality-control procedures. The V-TEC Mini has been tested to meet these relevant standards: EN360: 2002, ANSI Z359.14 – 2012, OSHA 1910.66, OSHA 1926.502, CSA Z259.2.2-98.

Ordering Information

Part No.	Single-Leg	Twin-Leg	Length	Anchorage connection	Harness connection
63011-00AEU	■		1.8 m	Aluminium scaffold hook	Steel carabiner
63011-00BEU	■		1.8 m	Steel snaphook	Steel carabiner
63011-00CEU	■		1.8 m	Aluminium swivel carabiner	Steel carabiner
63011-00DEU	■		1.8 m	Aluminium carabiner	Steel carabiner
63011-00EEU	■		1.8 m	Steel swivel hook	Steel carabiner
63011-00FEU	■		1.8 m	Steel scaffold hook	Steel carabiner
63011-00GEU	■		1.8 m	Aluminium scaffold hook	-
63011-00HEU	■		1.8 m	Steel snaphook	-
63011-00IEU	■		1.8 m	Aluminium swivel carabiner	-
63011-00JEU	■		1.8 m	Aluminium triple-lock carabiner	-
63011-00KEU	■		1.8 m	Steel swivel hook	-
63011-00LEU	■		1.8 m	Steel scaffold hook	-
63011-00MEU	■		1.8 m	Aluminium scaffold hook	Aluminium triple-lock carabiner
63011-00NEU	■		1.8 m	Triple-lock carabiner	Triple-lock carabiner
63011-00OEU	■		1.8 m	Steel snaphook	Steel scaffold hook
63011-00PEU	■		1.8 m	Aluminium triple-lock carabiner	Aluminium scaffold hook
63011-00REU	■		1.8 m	Aluminium snaphook	-
63011-00SEU	■		1.8 m	Aluminium rebar lightweight hook	Steel carabiner
63011-00TEU	■		1.8 m	Aluminium rebar lightweight hook	Aluminium carabiner triple locking captive pin
63011-00UEU	■		1.8 m	Aluminium rebar lightweight hook	-
63011-00VEU	■		1.8 m	Aluminium snaphook	Aluminium carabiner triple locking captive pin
63111-00AEU		■	1.8 m	Aluminium scaffold hook	TwinLink connector
63111-00BEU		■	1.8 m	Steel snaphook	TwinLink connector
63111-00CEU		■	1.8 m	Aluminium swivel carabiner	TwinLink connector
63111-00DEU		■	1.8 m	Aluminium triple-lock carabiner	TwinLink connector
63111-00EEU		■	1.8 m	Steel swivel hook	TwinLink connector
63111-00FEU		■	1.8 m	Steel scaffold hook	TwinLink connector
63111-00REU		■	1.8 m	Aluminium snaphook	TwinLink connector
63111-00SEU		■	1.8 m	Aluminium rebar lightweight hook	TwinLink connector

Part No.	
63900-04	TwinLink Connector for Mini PFL



Your direct contact

Great Britain
 Hopton Park, Devizes
 Wiltshire, SN10 2JP
 United Kingdom
 Phone +44 (0)800 066 2222
 info.gb@MSAsafety.com



For contact details of your local MSA affiliate, please visit our website.