



arachnipod

WINCH

APOD-WINCH20M



APOD-FBA Fall Arrest Block Adaptor is required to secure the winch to the Arachnipod or Industripod Series of tripods.



Specifications

DESIGNATION	Winch for raising or lowering personnel or material
MATERIAL	Polymer casing with 4.8 mm galvanised steel wire
LENGTH	20 metres
RATING	Maximum lifting load per EN 1496: 135 kg Maximum lifting load per Machinery Directive 2006/42/EC: 250 kg
STANDARDS	EN 1496; Machinery Directive 2006/42/EC
PRODUCT LIFE	10 years from Date of Manufacture (DOM) provided the unit is used, maintained and stored according to instructions and has not been subjected to extreme conditions or harsh environments.

SAFETY INFORMATION

Disclaimer

This manual contains general instructions for the use, operation and care of this product. The instructions are not all-inclusive. Safe and proper use of this product is solely at the discretion of the user. Safety information is included as a service to the user. All other safety measures taken by the user should be within and under consideration of applicable regulations and local protocol. Training on the proper use of this product must be provided before using this product in an actual situation.



Retain these instructions for future reference. Include it with the product in the event of transfer to new users. Additional copies are available upon request from Ferno.

Glossary

Anchor / Anchorage Point

A secure point of attachment on a structure to which a fall-arrest device may be connected.

Competent Person

A person who has, through a combination of training, education and experience, acquired knowledge and skills enabling that person to correctly perform a specified task.

WARNING

Warning safety alerts indicate a potentially hazardous situation that, if not avoided, could result in injury or death.

NOTICE

Notices emphasise important, but not hazard-related information. Failure to follow Notices could result in product or property damage.

Labels

Labels on the device provide important information including product name and code, wire length, serial and batch number plus the date of manufacture.

General Safety Instructions

Users must consult AS/NZS 1891.4 for selection, use, maintenance and training requirements and be competent in the use of equipment before beginning any tasks requiring its use. Users must read and understand the following warnings:

1. Working at heights can be dangerous. If you use Ferno equipment, you are responsible for learning and observing safe techniques. Ferno Australia disclaims all liability for any injury or loss arising from the use of this equipment when its hardware, stitching or webbing is frayed, damaged or in any way weakened by wear and tear.
2. This product is specifically designed for height safety and rescue purposes. It must not be used for other purposes.
3. The product must be regularly inspected and maintained in accordance with the manufacturer's recommendations and withdrawn from use if the product is deemed to be unsuitable for continued use by a competent person.
4. Do not make any alterations or additions to this product.
5. Secure your lanyard assembly to an anchorage point that allows you to carry out work tasks while also minimising your free-fall distance. The maximum allowable free-fall distance is 2m.
6. When making a connection to any point on a harness which cannot be seen by the wearer, either make the connection before donning the harness or have a second person make and check the connection for the wearer.
7. Always ensure any connections to a harness are checked before use.
8. Harnesses and lanyard assemblies should be removed from service and destroyed if a fall has been sustained.
9. Ensure the product is compatible with other items when assembled into a system. Other combinations and components not meeting these standards should not be used as they may compromise the safe operation of the system.
10. Ensure the Operator is in good physical and mental health and is trained and competent in the use of the device. The Operator must employ all relevant PPE for the job prior to commencement of working at height. PPE may include, but is not limited to a harness, lanyard, helmet, gloves and appropriate foot wear.
11. Ensure you have a rescue plan in place prior to working at height or confined space. A rescue plan is mandatory and all operators within the team must be aware of it prior to commencing work.



WARNING

- Do not use the APOD-WINCH20M beyond its specified limitations, or for any purpose other than that for which it is intended.
- Ensure the compatibility of equipment used within the system. Dangers may arise when the safe function of any one item of equipment is affected by or interferes with the safe function of another.
- Do not use your APOD-WINCH20M if any parts are missing.

INSTRUCTIONS FOR USE

Installing the Fall Arrest Block

Required Accessory: Fall Block Adaptor (APOD-FBA)

Tip

Tip for Faster Set Up

Feed the Winch wire through the pulley head BEFORE extending the Arachnipod or Industripod legs to working height.

Before securing the APOD-WINCH20M to an Arachnipod or Industripod Series of tripods (herein referred to as Industripod):

1. Lay the winch and the APOD-FBA Fall Block Adaptor (herein referred to as the Adaptor) onto a ground sheet next to the Arachnipod/Industripod.
2. Reel out several metres of wire and feed the connector and wire through the pulley. Clip the connector/karabiner to the Arachnipod/Industripod foot (Figure 1). Reinsert the pulley retaining pin to keep the wire in place on the pulley wheel.
3. Extend the Arachnipod/Industripod to the desired working height.

Installing the APOD-WINCH20M ARACHNIPOD

1. Attach the Adaptor to the:
 - a) **ARACHNIPOD** - Middle leg section (Figure 4)
 - a) **INDUSTRIPOD Series** - Top leg section (Figure 4) and secure it to the leg with the supplied pins (Figure 2).
2. Insert the Winch into the Adaptor. Ensure the cutout **A** on the winch rear bracket fits over the welded pin **B** at the base of the Adaptor (Figure 3). Slot the winch retaining pin through the Adaptor and winch, and keep it in place with the R-Clip.

Using the Fall Arrest Block

To release the wire for setup purposes:

1. Fit the winch handle to the quick release spindle as identified in Figure 5.
2. Rotate the handle anti-clockwise to disengage the winding mechanism. Maintain pressure on the handle while pulling the wire out. Releasing pressure on the handle will re-engage the gear.

To use under normal load:

- Fit the winch handle to the main gear spindle as identified in Figure 5.
- **To lower**, wind the handle clockwise.
- **To raise**, wind the handle anti-clockwise.

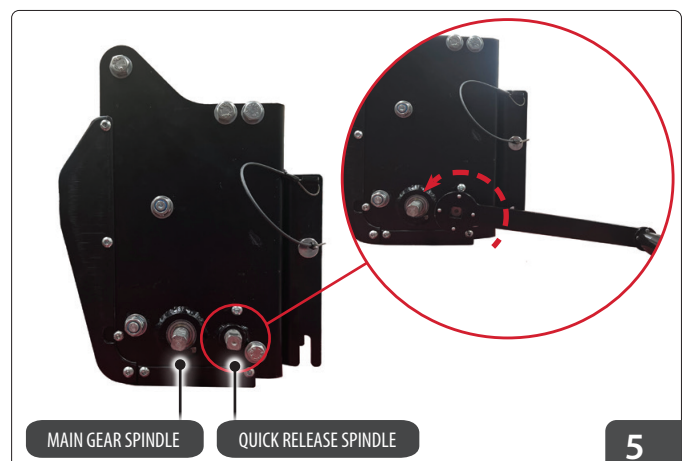
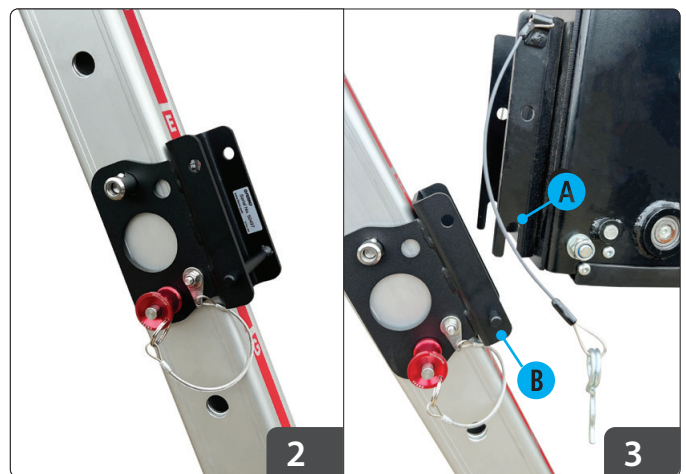

INSPECTION & MAINTENANCE

Inspection

To maintain the safety and serviceability of this product, the following inspections must be performed:

1. Operator Inspection

The operator shall inspect the product before and after each use (See Pre-Use Check List). Refer any signs of deterioration to a competent person for a decision on the safety and serviceability of the product.

2. Periodic Inspection

A full periodic inspection shall be conducted every twelve months (six months in marine conditions) by an Authorised Service Agent. Use the checklist as a guide for determining the condition of the product. Check for any sign of contaminants such as oil, grease, paint, etc.

WARNING: If any part of an assembly is to be exposed to chemicals, (eg. Cleaning materials or hazardous atmospheres) the user should consult the manufacturer to determine whether the part is suitable for continued use.

Periodic inspections shall be recorded in the product's Inspection and Maintenance log.

Maintenance

This product should be cleaned regularly to maintain its safety and serviceability. Clean as indicated below.

- After each use wipe down the product with a soft cloth or soft brush to remove any dust or dirt. Do not use abrasive materials to clean the product.
- If the product is very dirty, carefully wash the casing with water (maximum 50°C) using a neutral detergent. Air dry in a sheltered position away from direct heat sources.
- Store the product away from direct sunlight, excessive dust and moisture and corrosive atmospheres.

Inspect before each use

PRE-USE INSPECTION CHECKLIST	
ATTACHMENT POINTS	Any signs of distortion, rust or wear?
OUTER SHELL CASING	Any cracks, deformation, burns or signs of corrosion?
	Are screws and nuts in place and fully tightened?
WIRE CABLE (Wear gloves!)	Is the wire in good condition?
	Does the entire length of the wire extend and retract smoothly?
	Are there any signs of abrasion or damage?
FALL INDICATOR	Has the fall indicator been activated? If it has, do not use and remove the product from service
CONNECTORS	Do the levers move freely?
	Do the connectors lock properly?

GENERAL INSPECTION CHECK LIST Fall Arrest Blocks	
BLOCK HOUSING	Ensure casing bolts are tight
	Missing parts, cracks or wear, physical damage?
	Any unauthorised modifications?
WIRE CABLE (Wear Gloves!)	Ensure no kinks, cuts, needles or broken strands, crushed, jammed or flattened strands, signs of wire fatigue
	Signs of rust, pitting or corrosion
	Signs of heat damage, torch burns, electric arc strikes
	Overall deterioration, excessive outside wear
	Cable extends and retracts smoothly
SNAP HOOKS & KARABINERS	Distortion of hook or latch
	Cracks or forging folds
	Wear at swivels and latch pivot pin
	Open rollers
	Free movement of the latch over its full travel
	Broken, weak or misplaced latch springs (compare if possible with a new snap hook)

SUPPLIER			
DESIGNATION		WINCH FOR RAISING OR LOWERING PERSONNEL OR MATERIAL	
MODEL/ITEM #		MANUFACTURE DATE	
SERIAL #		PURCHASE DATE	
BATCH #		COMMISSIONED DATE	
INSPECTION AND MAINTENANCE RECORD			
DATE	NAME	DETAILS	